

BECA ISOLATORS

The "Beca" isolator is flexible both horizontally and vertically. It is particularly suitable for machines producing horizontal vibration forces. The horizontal deflections are approximately the same as the vertical deflections. The isolator is effective against all vibrations, irrespective of the direction in which they act.

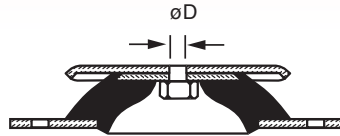
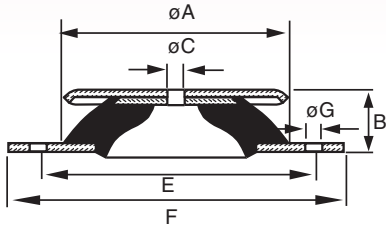

Part No.	DIMENSIONS							Weight Kg
	A	B	C	D	E	F	G	
M533641*	40	20	.	M6	52	64	6.2	0.05
M533661*	60	24	.	M6	76	90	6.2	0.2
M533581	80	27	8.1	-	100	120	8.2	0.3
M533109	100	28	10	-	124	148	10.2	0.5
M533152	150	39	14	-	182	214	12.2	1.4
M533203	200	44	18	-	240	280	14.5	3.1

*Supplied with Threaded Fixing Hole

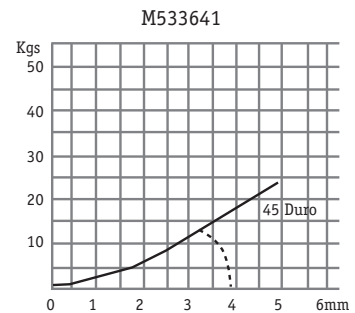
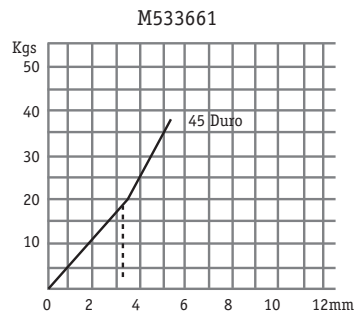
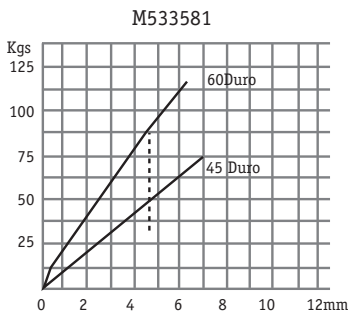
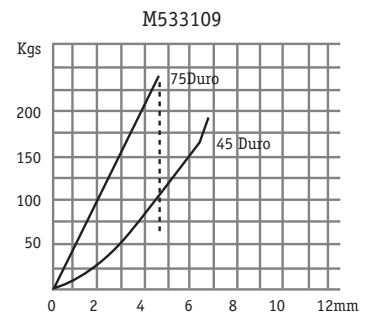
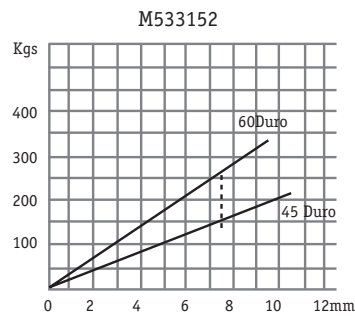
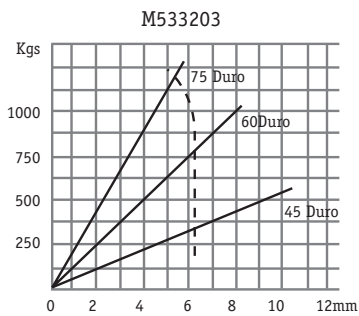

Part No.	LOAD RANGE kgs	NOMINAL DEFLECTION mm	DURO
M53364145	1 - 4	2	45
M53364160	2 - 10	2.5	60
M53366145	3 - 15	3	45
M53368145	11 - 45	4	45
M53368160	20 - 80	4	60
M53310945	22 - 90	4	45
M53358160	20 - 80	4	60
M53315245	30 - 130	7	45
M53310975	50 - 220	3	75
M53315260	60 - 250	7	60
M53320345	125 - 500	6	45
M53320360	200 - 825	6	60
M53320375	300 - 1250	5	75

COLOUR CODE	
DURO	COLOUR
45	Grey
60	Green
75	Red